

Ladies in Lavender
Set Plan and Build Schedule
15th -18th March 2018

Ladies in Lavender Set Build Plan Draft 1 19th January 2018



The set consists of 4 levels representing a bedroom, living room/hallway, outside door to garden and beach

Ladies in Lavender Set Build Plan Draft 1 19th January 2018



Set building time table:

Thursday 15th March: start time to be confirmed as either 930am or 12 noon

Main jobs:

- Put up staging including part of old extension
- Bring in flats, platform, steps etc from shed
- Put down stage carpets
- Put up flats
- Build special corner platform for bedroom

Friday 16th March 9am Main jobs:

- Finish construction
- Wallpapering
- Painting

Saturday 17th March 9am

Main jobs

- Lighting
- Sound
- Black curtaining
- Flies

Sunday 18th March Main jobs

- Set dressing
- First rehearsal on stage

Sunday 25th March 930am Take it all down and put everything away!!

Ladies in Lavender Set Build Plan Draft 1 19th January 2018

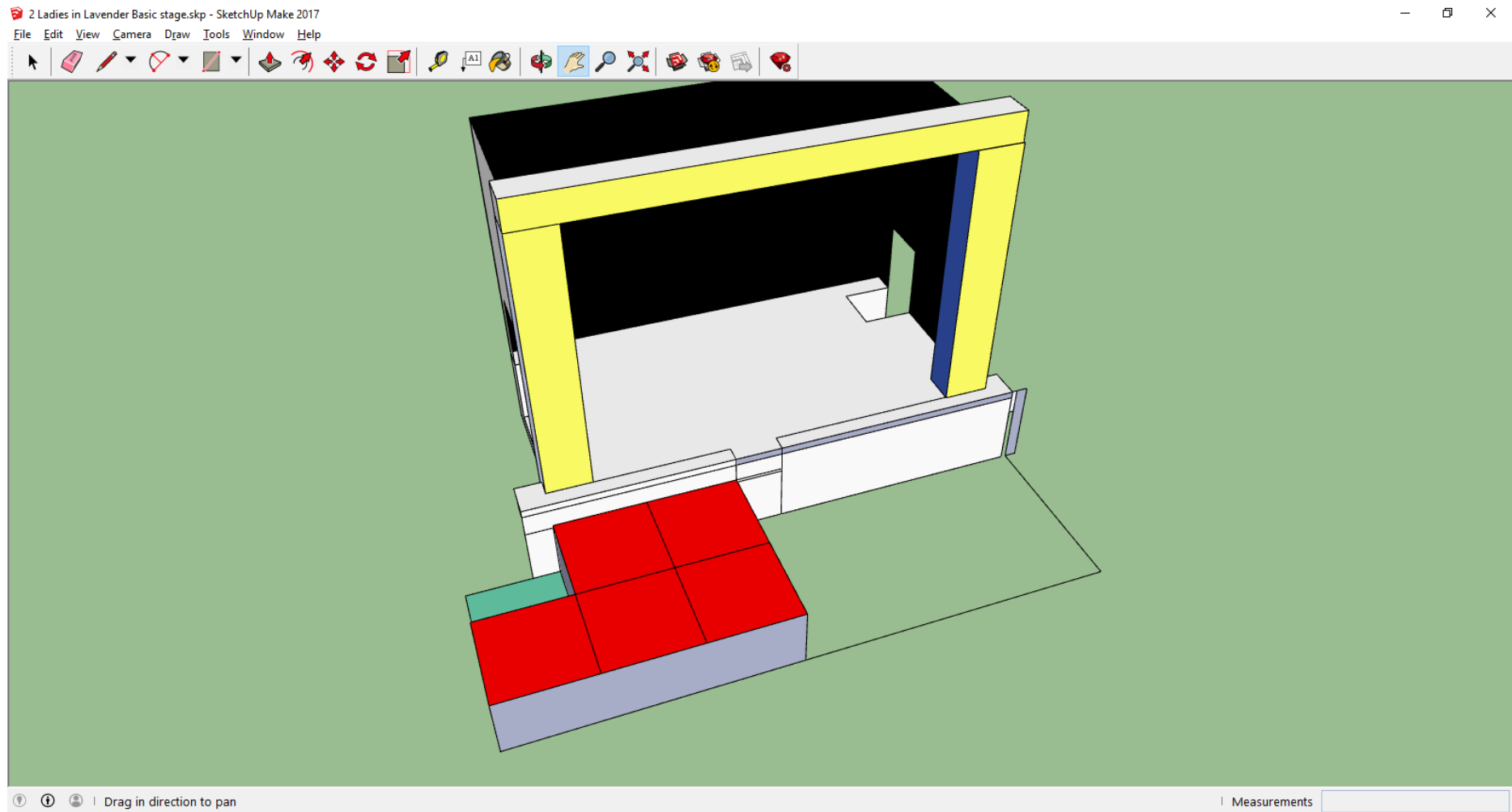

Assemble stage blocks for garden area. 5 blocks with medium leg extensions

Ladies in Lavender Set Build Plan Draft 1 19th January 2018

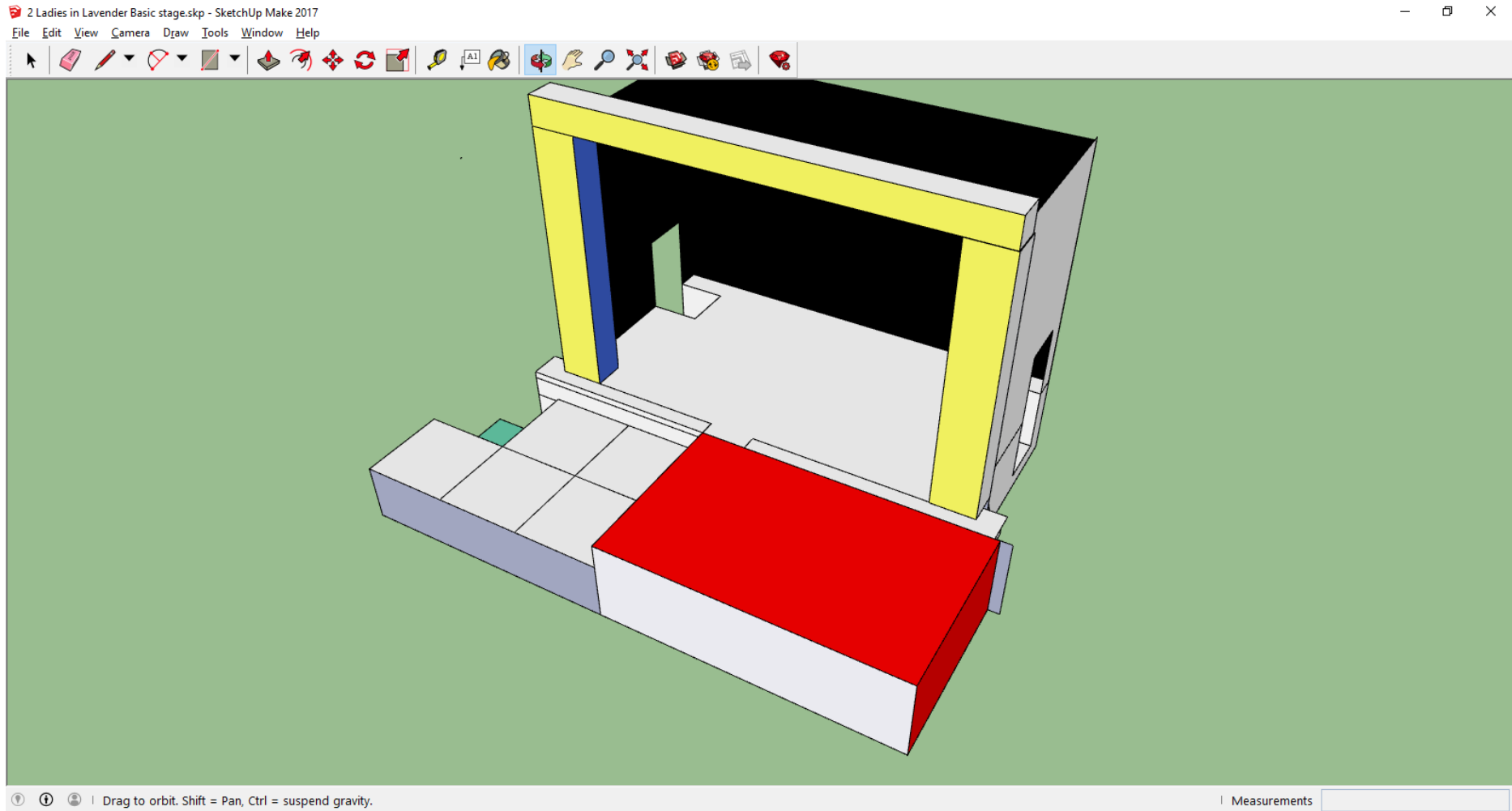

Assemble stage left extension for living room using 2/3 of old stage extension (4 boards)

Carpet original stage and old extension

Ladies in Lavender Set Build Plan Draft 1 19th January 2018

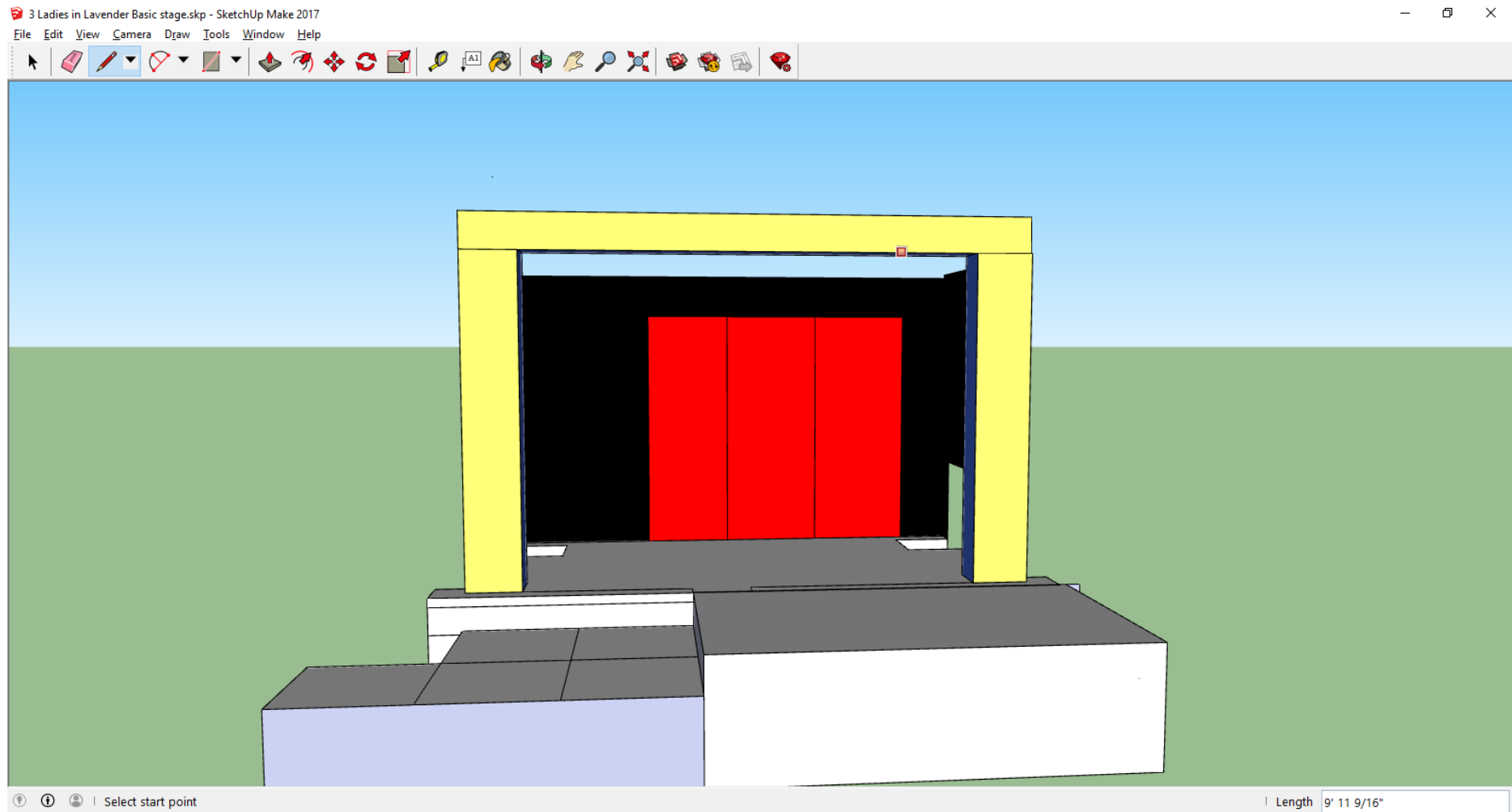

Put flats against back wall for rear wall of bedroom: Three 4ft flats

Ladies in Lavender Set Build Plan Draft 1 19th January 2018

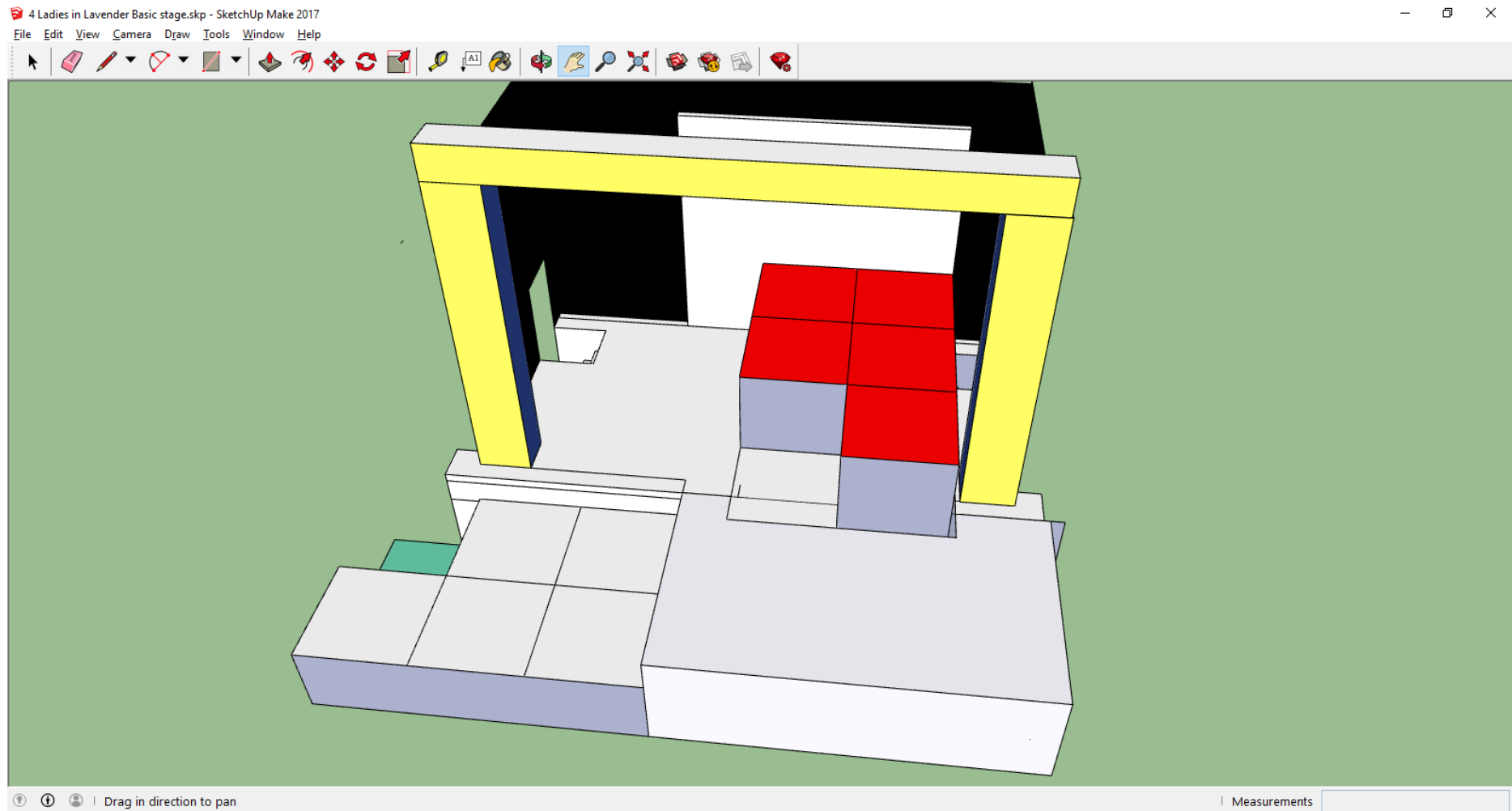

Assemble blocks for bedroom. 5 blocks with full height leg extensions

Ladies in Lavender Set Build Plan Draft 1 19th January 2018

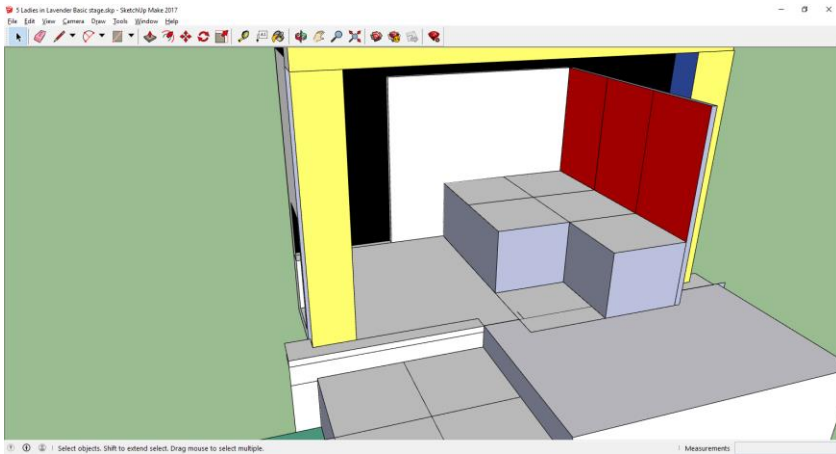

Build SL bedroom wall. Three 4ft flats

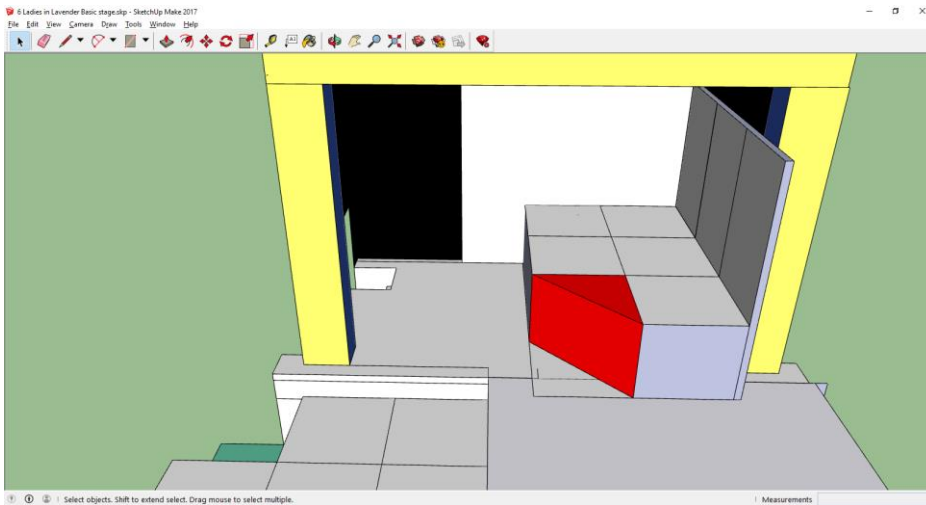

Construction of special corner for bedroom floor

Ladies in Lavender Set Build Plan Draft 1 19th January 2018

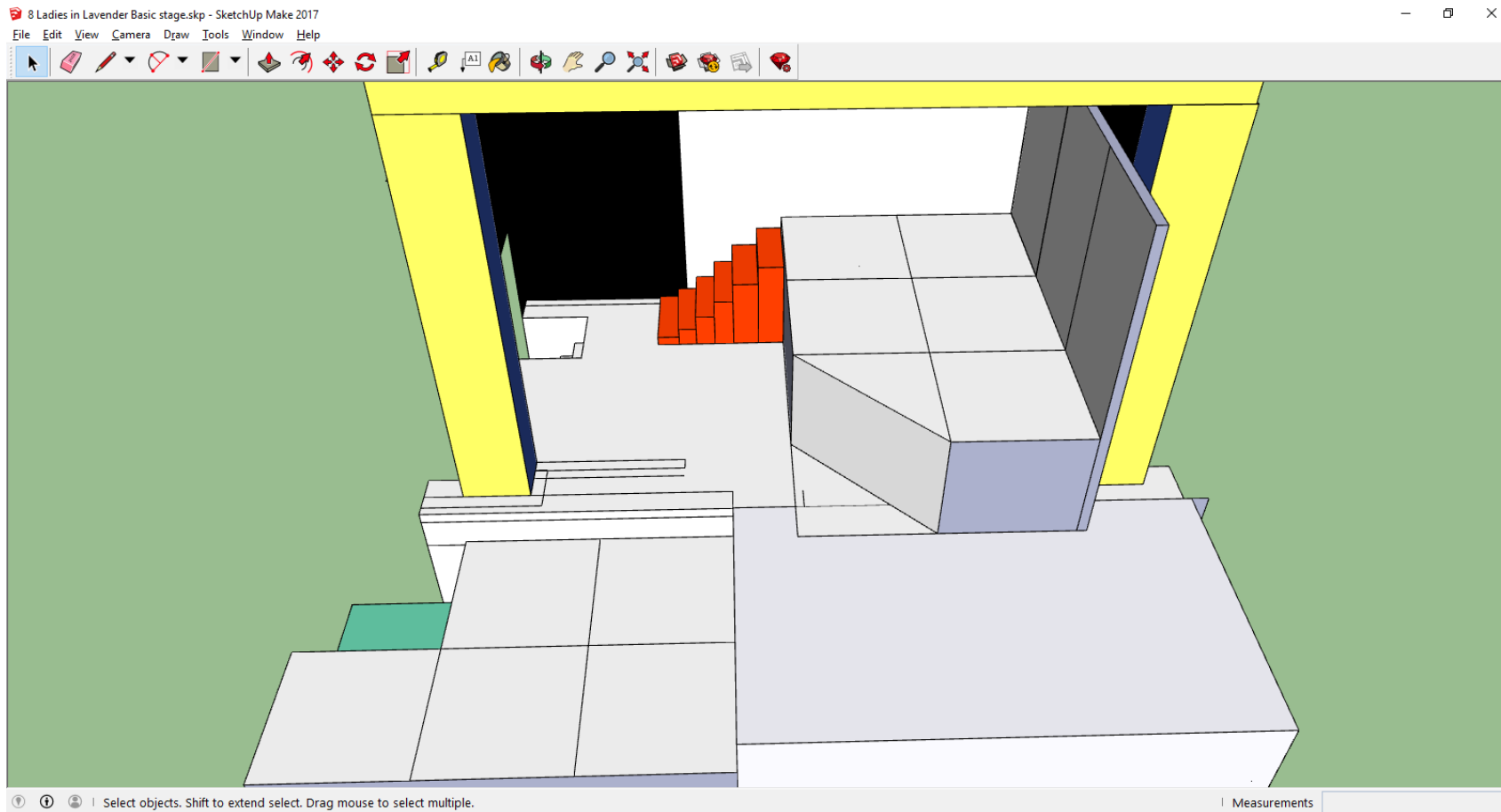

Place set of steps upstage for entrance to bedroom

Ladies in Lavender Set Build Plan Draft 1 19th January 2018

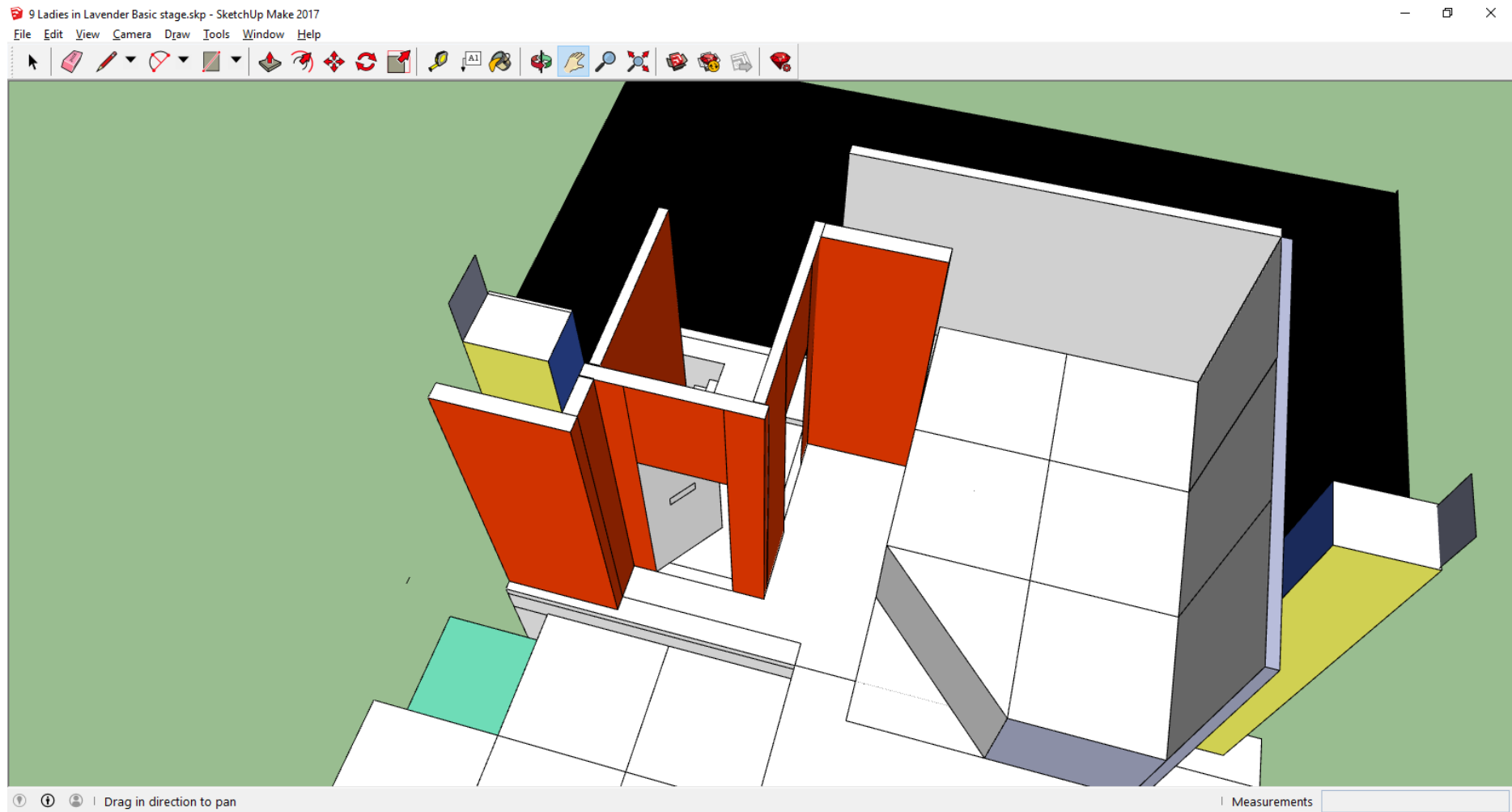

Assemble flats to create outside door and wall, hall wall with exit from living room and internal hall wall.

Ladies in Lavender Set Build Plan Draft 1 19th January 2018

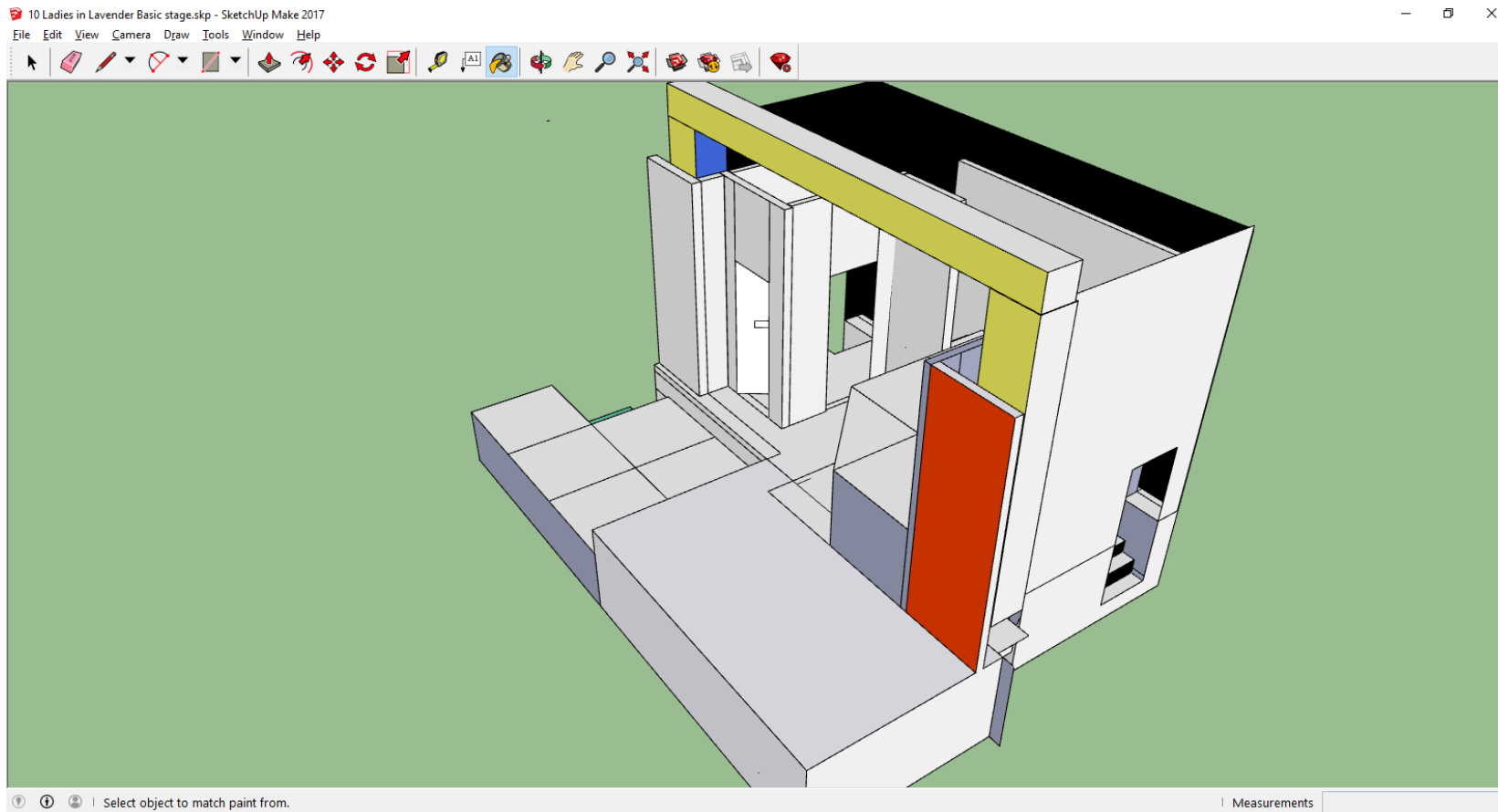

Living room wall SL (3ft flat)

Ladies in Lavender Set Build Plan Draft 1 19th January 2018

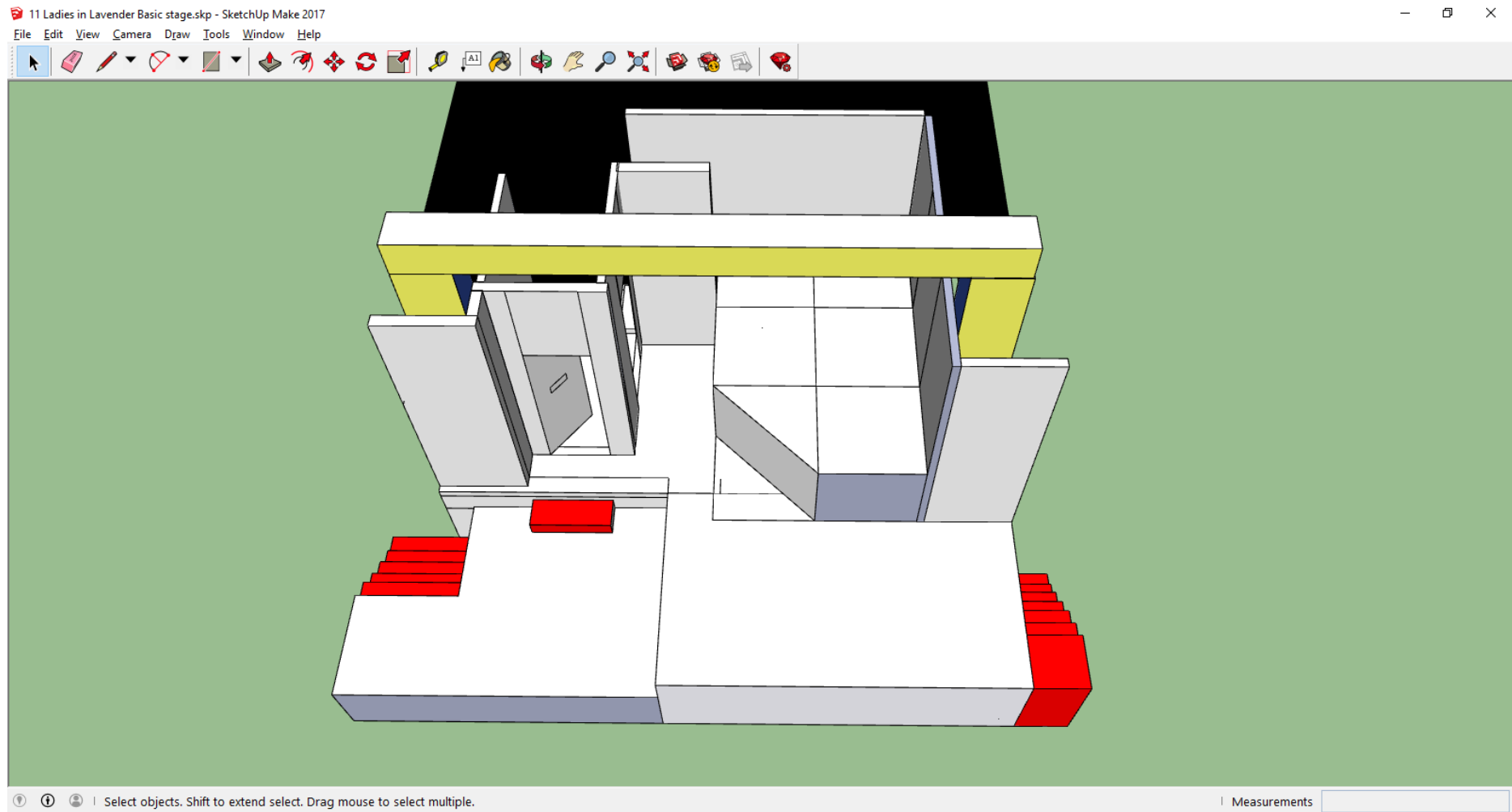

Steps SL and SR and step from door into garden

Ladies in Lavender Set Build Plan Draft 1 19th January 2018



Wall paper:

External – brick effect 2 rolls

Bedroom – wallpaper to be selected 4 rolls

Living Room – wall paper to be selected 4 rolls

Ladies in Lavender Set Build Plan Draft 1 19th January 2018



Grass effect carpet for garden and bedroom room carpet

Ladies in Lavender Set Build Plan Draft 1 19th January 2018



Black curtain around hall door exits and across front of extensions

Ladies in Lavender Set Build Plan Draft 1 19th January 2018



Assemble blocks for beach and carpet with yellow carpet

Put up blue curtain above stage. Black flies to hide proscenium and black boards along top of flats

Ladies in Lavender Set Build Plan Draft 1 19th January 2018

Mask behind front door and kitchen door – decorate if required

Set lights

Put in talk back

Set up lighting and sound table

Set up speakers

Carpet backstage

Set up props table

Set up back stage video link and TV

Set up bar in lobby

